

ROHS

REV.	ECN NO	DESCRIPTION	REVISED	DATE
A		新订图面	HELLER	2018.12.18

Specifications / 技术规格:

Current rating: 7A
 额定电流: 7A
 Voltage rating: 250V AC,DC
 额定电压: 250V AC,DC
 Insulation Resistance: 1000MΩ Min.
 绝缘电阻: 最小1000MΩ
 Dielectric Withstanding: 1500V AC 1Min
 耐电压: 1500V AC 1分钟
 Contact Resistance: 20mΩ Max.
 接触电阻: 最大20mΩ
 Operating Temperature: -25°C to +85°C
 工作温度: -25°C 到 85°C

Materials / 材料:

Contact Material: Brass(Tin Plating)
 接触端子材料: 黄铜(镀锡)
 Insulation Material: PA or PBT UL94V-2
 绝缘塑胶材质: PA 或 PBT UL94V-2

CKT.	DIM (mm)	
	A	B
2	3.96	7.92
3	7.92	11.88
4	11.88	15.84
5	15.84	19.80
6	19.80	23.76
7	23.76	27.72
8	27.72	31.68
9	31.68	35.64
10	35.64	39.60
11	39.60	43.56
12	43.56	47.52
13	47.52	51.48
14	51.48	55.44
15	55.44	59.40

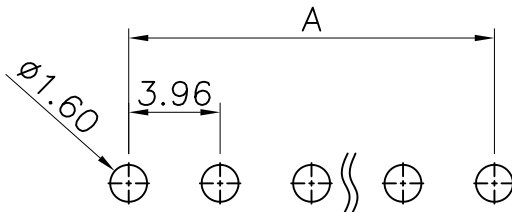
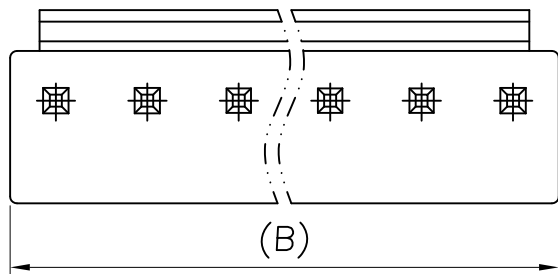

Recommended P.C.Board Hole Layout

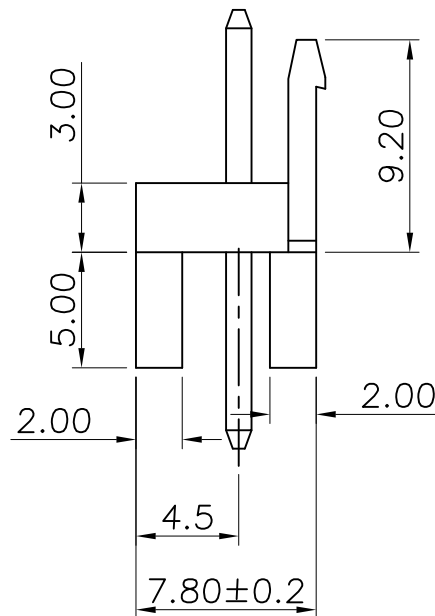
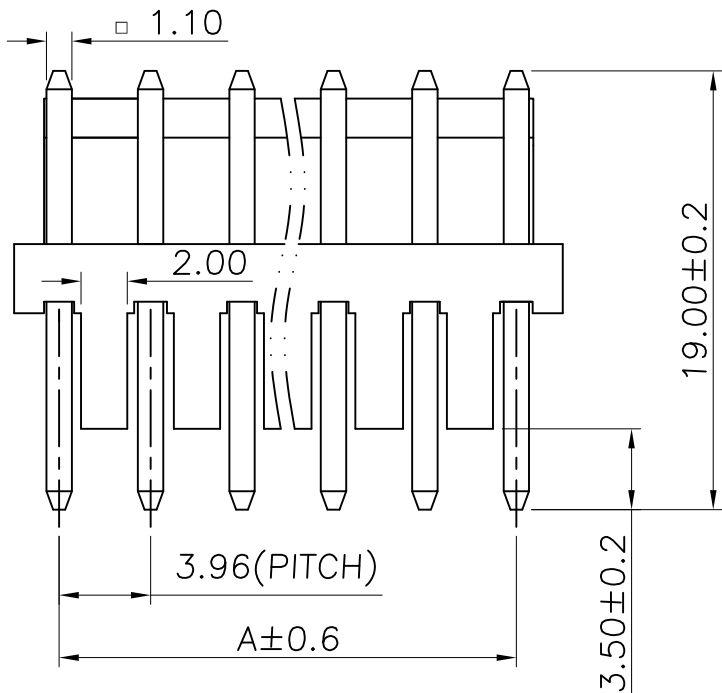

浙江快利电子有限公司
 Zhejiang Kuaili Electronic Co., Ltd

GENERAL TOLERANCE

X.* ± 3°	.XXX: ±0.10
.X° ± 2°	.XX: ±0.25
.XX* ± 1°	.X: ±0.30
.XXX* ± 0.5°	X: ±0.35

DESIGN:	HELLER	DATE:	18'.12.18
CHECKED:	瞿益远	DATE:	18'.12.18
AUDITED:	朱建慧	DATE:	18'.12.18
APPROVED:	朱建华	DATE:	18'.12.18

DWG. NO.	
PART NO.	KL-VHS-NA

TITLE:
VHS-NA 连接器

REV.	A	UNIT.	MM	SCALE.	1:1
------	---	-------	----	--------	-----

