

REV.	ECN NO	DESCRIPTION	REVISED	DATE
A		新订图面	LXM	2016.4.15

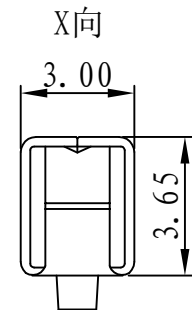
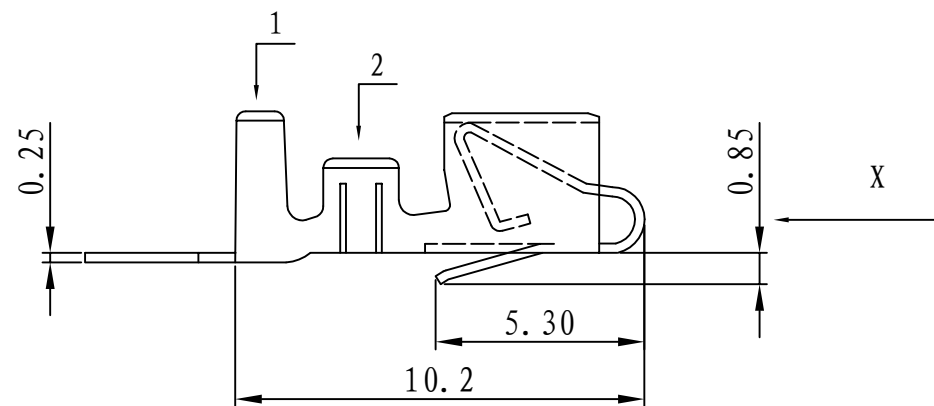
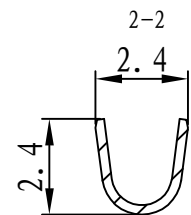
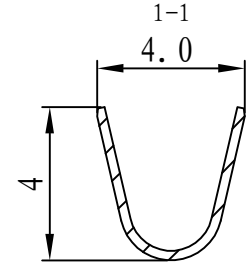
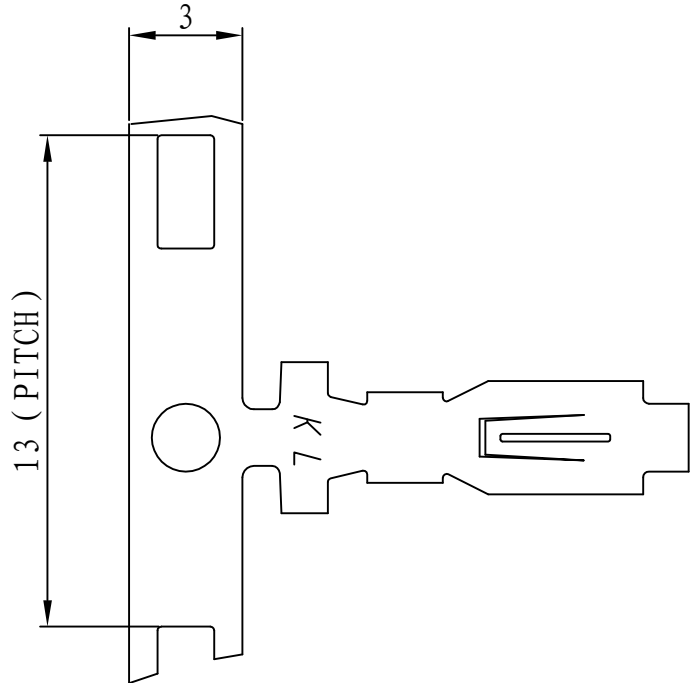

Specifications /技术规格:

Current Rating: 7A  
 额定电流: 7A

Insulation Resistance: 1000MΩ Min.  
 绝缘电阻: 最小1000MΩ

Dielectric Withstanding: 1500V AC  
 耐电压: 1500V AC

Contact Resistance: 30mΩ Max.  
 接触电阻: 最大30mΩ

Operating Temperature: -25°C to +85°C  
 工作温度: -25°C 到 85°C

Materials /材料:

Contact Material: Phosphor Bronze(Tin plating)  
 接触端子材料: 磷铜(镀锡)

 浙江快利电子有限公司  
 ZheJiang KuaiLi Electronic Co., LTD.

GENERAL TOLERANCE	
X.: ± 3°	X.: ± 0.35
.X: ± 2°	X.X: ± 0.25
.XX: ± 1°	X.XX: ± 0.15
.XXX: ± 0.5°	X.XXX: ± 0.10

DESIGN:	LXM	DATE:	2016-04-15
CHECKED:	李晓明	DATE:	2016-04-15
APPROVED:	朱建华	DATE:	2016-04-15

DWG. NO.	
PART NO.	KL-VH-TE

TITLE.	VH-TE (24.8)
--------	--------------

REV.	UNIT.	SCALE.	PAGE.	PROJ.
A	mm	-	1/1	