

REV.	ECN NO	DESCRIPTION	REVISED	DATE
A		新订图面	HELLER	2017.7.22

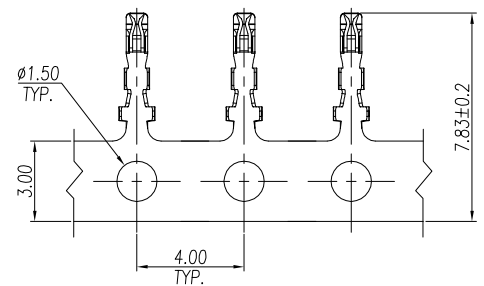

排样图
SC 0.25:1

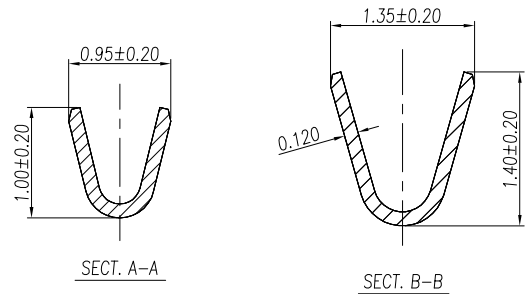
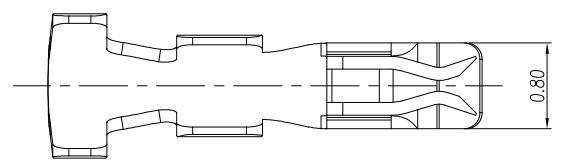
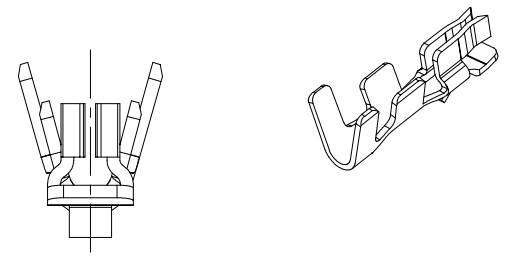
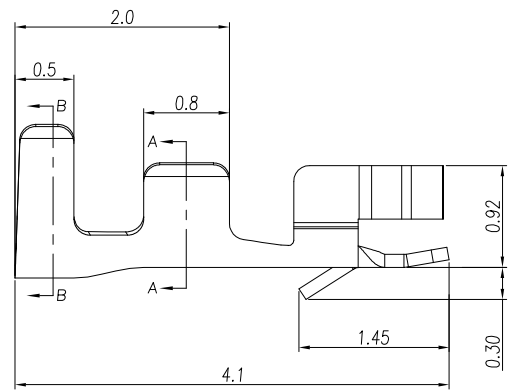

Specifications / 技术规格:

- Current Rating: 1A
额定电流: 1A
- Voltage rating: 125V AC, DC
额定电压: 125V AC, DC
- Insulation Resistance: 100 MΩ Min.
绝缘电阻: 最小100MΩ
- Dielectric Withstanding: 500V AC
耐电压: 500V AC
- Contact Resistance: 20mΩ Max.
接触电阻: 最大20mΩ
- Operating Temperature: -25°C to +85°C
工作温度: -25°C 到 85°C

Materials / 材料:

Contact Material: Phosphor Bronze (Tin plated)
接触端子材料: 磷铜 (镀锡)

浙江快利电子有限公司
ZheJiang KuaiLi Electronic Co., Ltd.

GENERAL TOLERANCE	
X° ± X'	.XXX: ±0.05
.X° ± X'	.XX: ±0.10
.XX° ± 1'	.X: ±0.20
.XXX° ± 0.5'	X.: ±0.30

DESIGN: 瞿益远
CHECKED: 朱建慧
APPROVED: 朱建华

DATE: 2017.7.22
DATE: 2017.7.22
DATE: 2017.7.22

DWG. NO.
PART NO.
KL-SHJ-TE

TITLE.
SHJ-TE 端子

REV.	A	UNIT.	MM	SCALE.	-