

1 2 3 4 5 6 7 8 9

**ROHS**

REV.	ECN NO	DESCRIPTION	REVISED	DATE
A		新订图面	KEVIN	15.03.10
B	20150806001	取消台阶	KEVIN	15.08.06

Specifications / 技术规格:

Current rating: 2A  
 额定电流: 2A  
 Voltage rating: 250V AC,DC  
 额定电压: 250V AC,DC  
 Insulation Resistance: 1000MΩ Min.  
 绝缘电阻: 最小1000MΩ  
 Dielectric Withstanding: 800V AC 1Min  
 耐电压: 800V AC 1分钟  
 Contact Resistance: 20mΩ Max.  
 接触电阻: 最大20mΩ  
 Operating Temperature: -25°C to +85°C  
 工作温度: -25° C 到85° C

Materials / 材料:  
 Insulation Material: PA or PBT UL94V-2 Natural  
 绝缘体塑胶材料: PA 或 PBT UL94V-2 本色

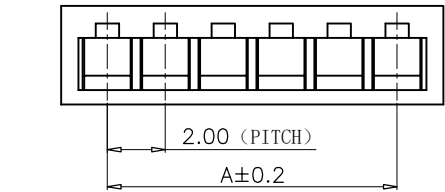
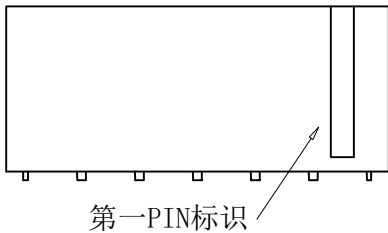
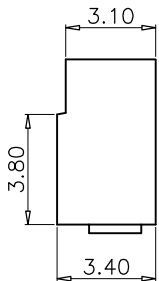
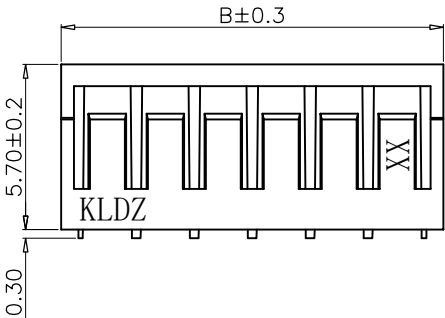
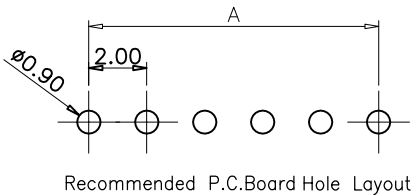
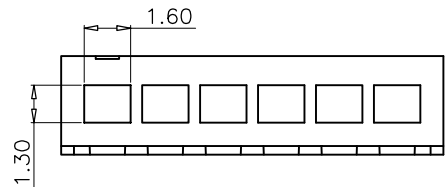

CKT.	尺寸 (mm)	
	A	B
2	2.00	5.20
3	4.00	7.20
4	6.00	9.20
5	8.00	11.20
6	10.00	13.20
7	12.00	15.20
8	14.00	17.20
9	16.00	19.20
10	18.00	21.20
11	20.00	23.20
12	22.00	25.20
13	24.00	27.20
14	26.00	29.20
15	28.00	31.20
16	30.00	33.20

浙江快利电子有限公司  
 Zhejiang Kuaili Electronic Co., Ltd

GENERAL TOLERANCE	
X.* ± 3*	.XXX: ±0.10
.X* ± 2*	.XX : ±0.15
.XX* ± 1*	.X : ±0.25
.XXX* ± 0.5*	X. : ±0.35

DESIGN: KEVIN	DATE: 2015-08-06
CHECKED:	DATE:
AUDITED:	DATE:
APPROVED:	DATE:

DWG. NO.	PART NO. KL-SAN-NY
DATE:	
DATE:	
DATE:	

TITLE:  
 SAN-NY

REV. B	UNIT. MM	SCALE. 1:1	
--------	----------	------------	--

1 2 3 4 5 6 7 8 9