

此处刻公司LOGO(KL或KLDZ),具体以实物为准

2-2

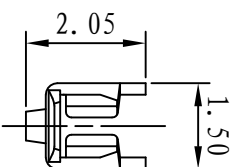
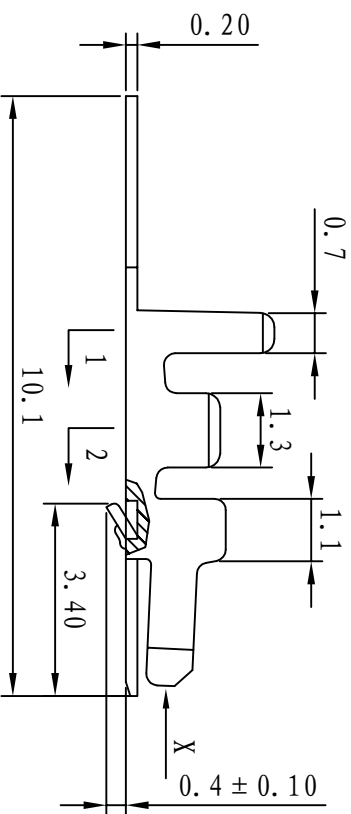
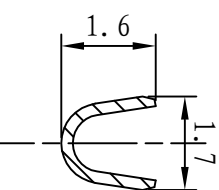

X向

Specifications / 技术规格:

- Current Rating: 3A
  - 额定电流: 3A
  - Insulation Resistance: 1000 MΩ Min.
  - 绝缘电阻: 最小1000MΩ
  - Dielectric Withstanding: 800V AC
  - 耐压: 800V AC
  - Contact Resistance: 20mΩ Max.
  - 接触电阻: 最大20mΩ
  - Operating Temperature: -25°C to +85°C
  - 工作温度: -25° C 到 85° C
- Materials / 材料:
- Contact Material: Phosphor Bronze (Tin plated)
  - 接触端子材料: 磷铜 (镀锡)

GENERAL TOLERANCE

X' ± 3'	X.	±0.35
.X' ± 2'	.X.	±0.25
.XX' ± 1'	.XX	±0.15
.XXX' ± 0.5'	.XXX	±0.10

DESIGN: KEVIN

CHECKED: SOUL	DATE: 13'.2.20
AUDITED: 张宁	DATE: 13'.2.21
APPROVED: 朱建华	DATE: 13'.2.22

DWG. NO.

-----

TITLE:

PHDS-TTE

REV.

A	UNIT: MM	SCALE: ---	
---	----------	------------	--



浙江快利电子有限公司  
Zhejiang Kuaili Electronic Co., Ltd

A

B

C

D

E

F

A

B

C

D

E

F

1 2 3 4 5 6 7 8 9