

REV.	ECN NO	DESCRIPTION	REVISED	DATE
A		新订图面	LXM	16'.03.09

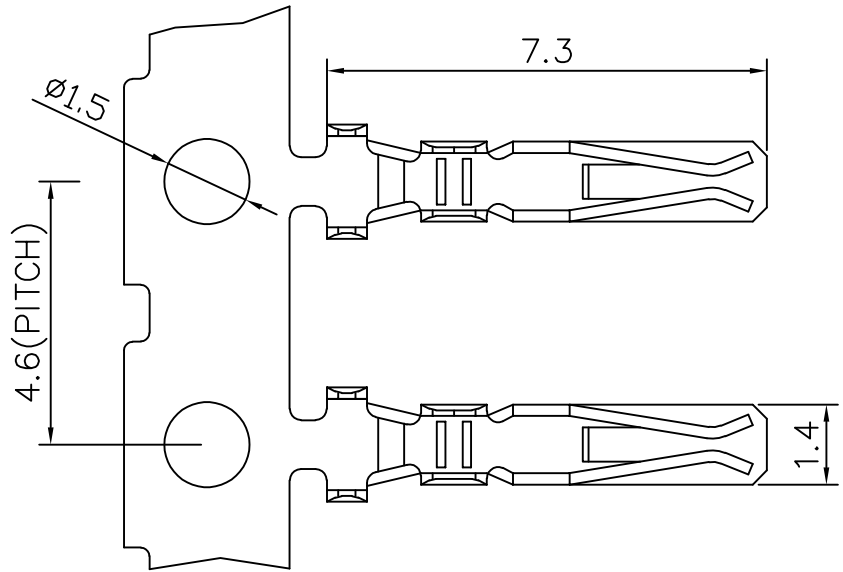
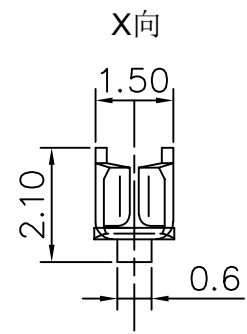
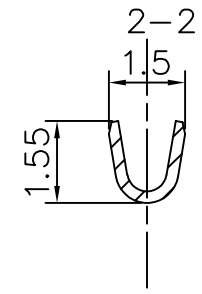
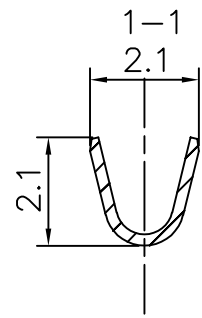
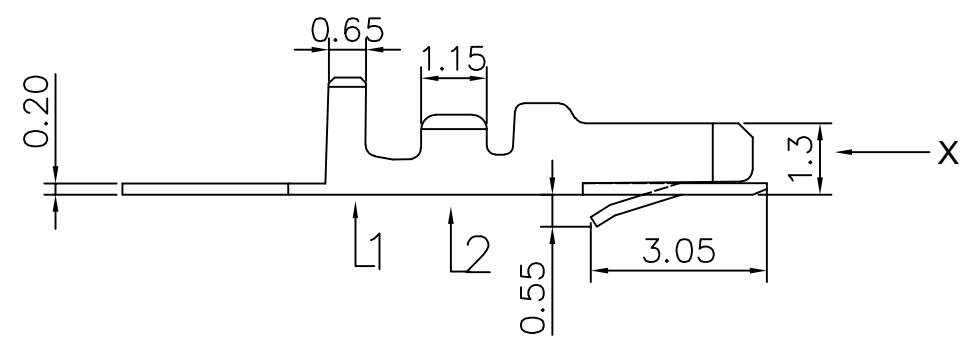

Specifications / 技术规格:

Current Rating: 3A
额定电流: 3A

Insulation Resistance: 1000MΩ Min.
绝缘电阻: 最小1000MΩ

Dielectric Withstanding: 800V AC
耐电压: 800V AC

Contact Resistance: 20mΩ Max.
接触电阻: 最大20mΩ

Operating Temperature: -25°C to +85°C
工作温度: -25°C 到 85°C

Materials / 材料:

Contact Material: Phosphor Bronze(Tin plating)
接触端子材料: 磷铜(镀锡)

Recommended wire gauge: AWG28#-24#
推荐线规: AWG28#-24#

浙江快利电子有限公司
Zhejiang Kuaili Electronic Co., Ltd

GENERAL TOLERANCE	
X.* ± X.*	.*** ±0.10
.X* ± X.	.** ±0.15
.XX* ± XX.	. * ±0.25
.XXX* ± 0.5*	*. ±0.35

DESIGN:	李晓明	DATE:	16'.03.09
CHECKED:	李晓明	DATE:	16'.03.09
AUDITED:	张宁	DATE:	16'.03.09
APPROVED:	朱建华	DATE:	16'.03.09

DWG. NO.	
PART NO.	KL-PHB-B-TE-2824

TITLE.	PHB-B-TE
--------	----------

REV.	A	UNIT.	MM	SCALE.	---	
------	---	-------	----	--------	-----	--