

REV.	ECN NO	DESCRIPTION	REVISED	DATE
A		新订图面	KEVIN	2016.4.18

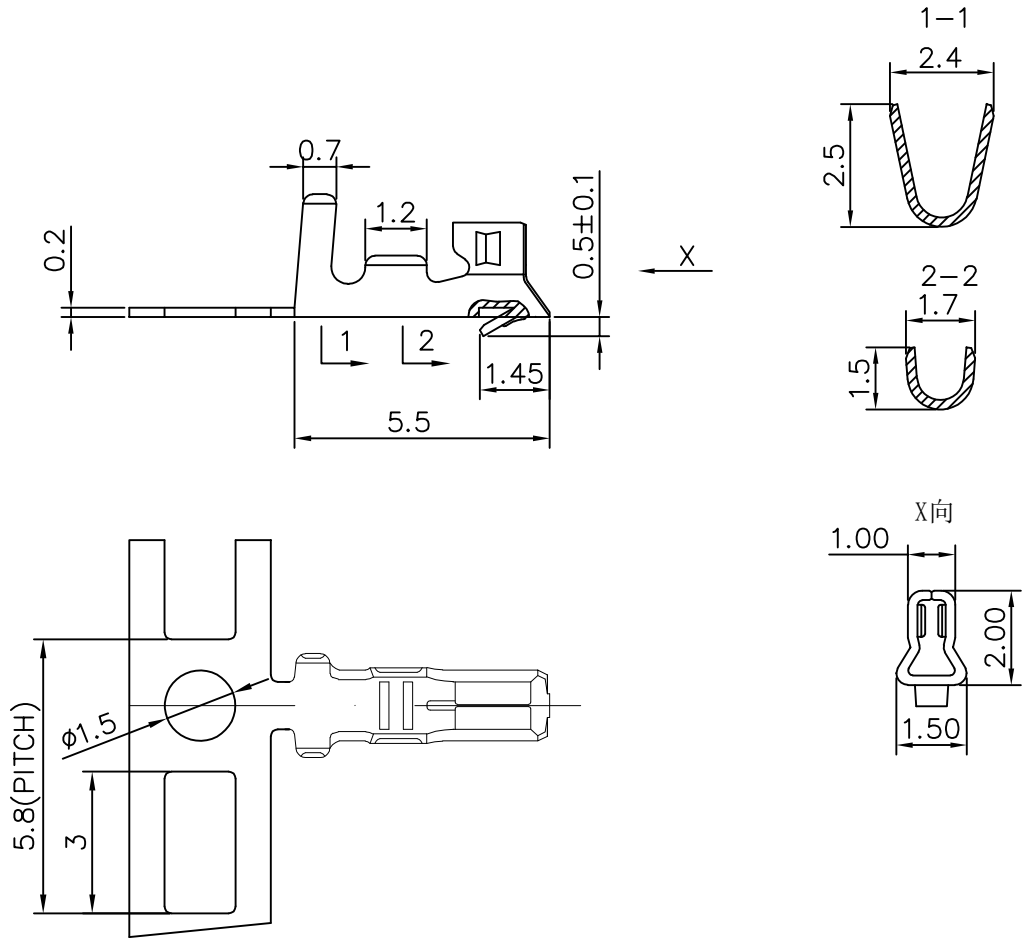

Specifications /技术规格:

Current Rating: 2A  
 额定电流: 2A  
 Insulation Resistance: 1000MΩ Min.  
 绝缘电阻: 最小1000MΩ  
 Dielectric Withstanding: 800V AC  
 耐电压: 800V AC  
 Contact Resistance: 20mΩ Max.  
 接触电阻: 最大20mΩ  
 Operating Temperature: -25°C to +85°C  
 工作温度: -25°C 到 85°C

Materials /材料:

Contact Material: Phosphor Bronze(Tin plating)  
 接触端子材料: 磷铜(镀锡)  
 wire gage: 30AWG-24AWG  
 线规: 30AWG-24AWG

 浙江快利电子有限公司  
 ZheJiang KuaiLi Electronic Co., LTD.

GENERAL TOLERANCE	
X: ±3°	X.: ±0.35
.X: ±2°	X.X: ±0.25
.XX: ±1°	X.XX: ±0.15
.XXX: ±0.5°	X.XXX: ±0.10

DESIGN: KEVIN  
 CHECKED: 李晓明  
 APPROVED: 朱建华

DATE: 2016-04-18  
 DATE: 2016-04-18  
 DATE: 2016-04-18

DWG. NO.  
 PART NO.  
 KL-PH-TE-3024

TITLE.  
 PH-TE (17.6)

REV.	UNIT.	SCALE.	PAGE.	PROJ.
A	mm	-	1/1	