

REV.	ECN NO	DESCRIPTION	REVISED	DATE
A	/	新订图面	KEVIN	2015.5.15
B	20170411001	牙齿加胶, 挂钩尾部取消倒角	HELLER	2017.4.11
C	20180409001	修改 © 处尺寸	HELLER	2018.4.9

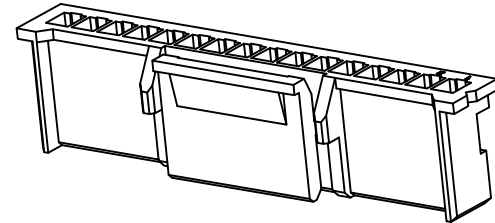

CKT.	A	B	C	D	E
2	2.00	4.30	6.00	2.60	
3	4.00	6.30	8.00	3.80	/
4	6.00	8.30	10.00		
5	8.00	10.30	12.00		
6	10.00	12.30	14.00	4.50	7.80
7	12.00	14.30	16.00		
8	14.00	16.30	18.00		
9	16.00	18.30	20.00		
10	18.00	20.30	22.00		
11	20.00	22.30	24.00		
12	22.00	24.30	26.00	11.00	14.40
13	24.00	26.30	28.00		
14	26.00	28.30	30.00		
15	28.00	30.30	32.00		

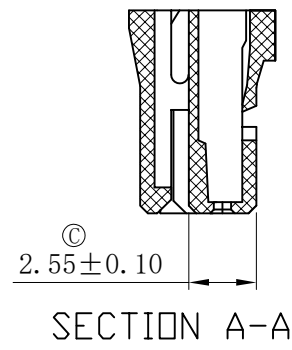
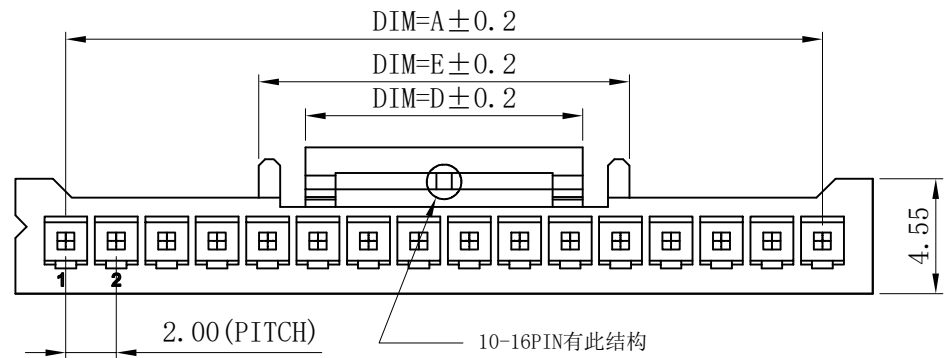
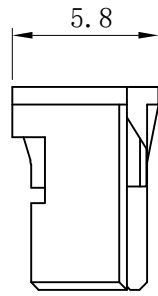
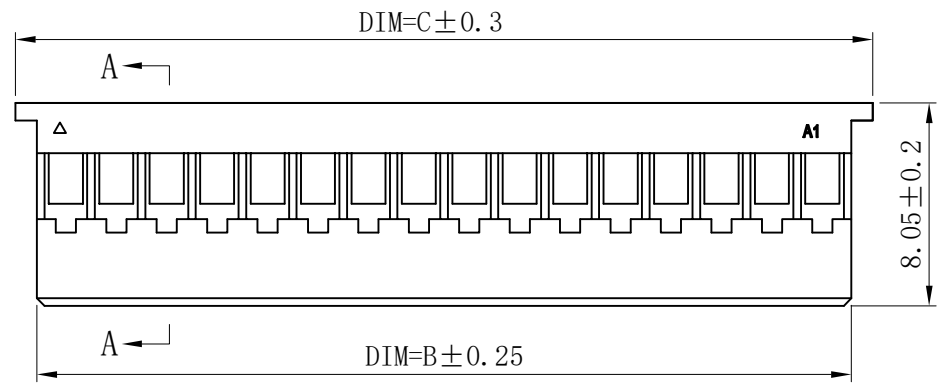

Specifications / 技术规格:
Current Rating: 3A AC,DC(AWG#22)
 额定电流: 3A AC,DC(AWG#22)
Insulation Resistance: 1000MΩ Min.
 绝缘电阻: 最小1000MΩ
Dielectric Withstanding: 800V AC
 耐电压: 800V AC
Operating Temperature: -25°C to +85°C
 工作温度: -25°C 到 85°C

Materials / 材料:
Insulation Material: PA or PBT UL94V-2
 绝缘体塑胶材料: PA 或 PBT UL94V-2

浙江快利电子有限公司
 Zhejiang Kuaili Electronic Co., Ltd

GENERAL TOLERANCE	
X.° ± 3'	X.: ±0.10
.X° ± 2'	.X: ±0.15
.XX° ± 1'	.XX: ±0.25
.XXX° ± 0.5'	.XXX: ±0.35

DESIGN:	HELLER	DATE:	2018.4.9
CHECKED:	瞿益远	DATE:	2018.4.9
AUDITED:	曹德友	DATE:	2018.4.9
APPROVED:	朱建华	DATE:	2018.4.9

DWG. NO.	
PART NO.	KL-PA-NY-01-W

TITLE.	PA-NY
--------	-------

REV.	C	UNIT.	MM	SCALE.	1:1	
------	---	-------	----	--------	-----	--