

成品图

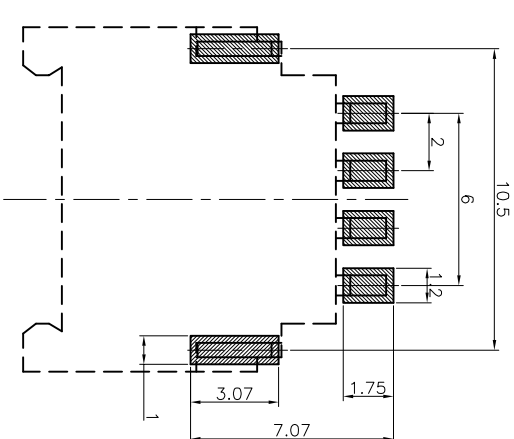
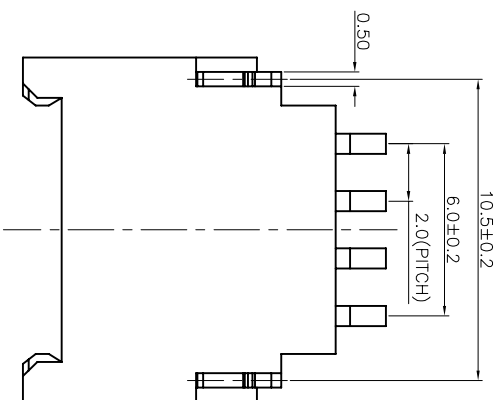
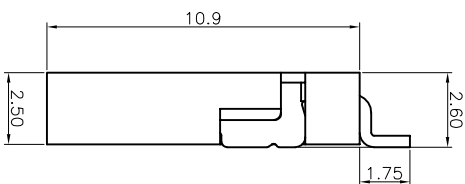
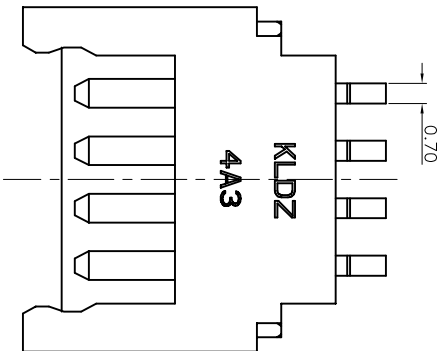
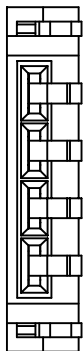

RECOMMENDED P.C. BOARD LAYOUT(TOP VIEW)
GENERAL TOLERANCE : ±0.05

Specifications / 技术规格:

- Current rating: 2A
 - Voltage rating: 125V AC,DC
 - 额定电压: 125V AC,DC
 - Insulation Resistance: 1000MΩ Min.
 - 绝缘电阻: 最小1000MΩ
 - Dielectric Withstanding: 500V AC 1Min
 - 耐电压: 500V AC 1分钟
 - Contact Resistance: 20mΩ Max.
 - 接触电阻: 最大20mΩ
 - Operating Temperature:-25°C to +85°C
 - 工作温度: -25° C 到85° C
- Materials / 材料:
- Contact Material: Brass (Tin plating)
 - 接触端子材料: 黄铜(镀锡)
 - Soldering Material: Phos.bronze (Tin plating)
 - 焊脚材料: 磷铜(镀锡)
 - Insulation Material: LCP or PA UL94V-0
 - 绝缘体塑胶材质: LCP 或 PA UL94V-0

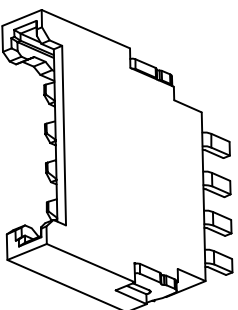
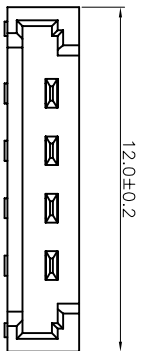

浙江快利电子有限公司
Zhejiang Kuaile Electronic Co., LTD

REV. A UNIT: mm SCALE: - PAGE: 1/1 PROJ.

1 2 3 4 5 6 7 8 9

REV.	ECN NO	DESCRIPTION	REVISED	DATE
A		新订图面	KEVIN	2013.9.15

GENERAL TOLERANCE		DESIGN:	
X: ±3°	X: ±0.35	KEYIN	KEVIN
X: ±2°	X.X: ±0.25	CHECKED:	谢书良
.XX: ±1°	X.XX: ±0.15	APPROVED:	朱建华
.XXX: ±0.5°	X.XXX: ±0.10	DATE:	2013-09-15

DWG. NO.	TITLE.
KL-CB2.0-4AWT	超薄2.0 4P贴片母座 CB2.0-4AWT