

REV.	ECN NO	DESCRIPTION	REVISED	DATE
A		新订图面	HELLER	

ROHS

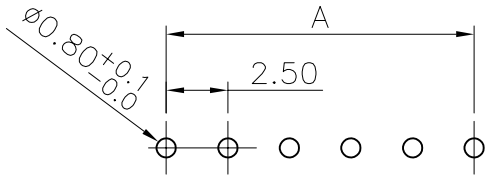
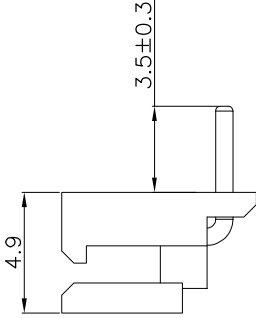
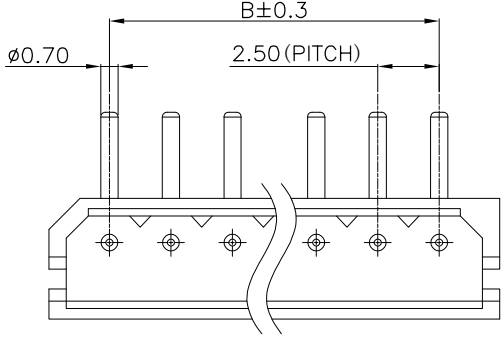

Recommended P.C.Board Hole Layout

P N 数	尺寸 (mm)	
	A	B
2	7.40	2.50
3	9.90	5.00
4	12.40	7.50
5	14.90	10.00
6	17.40	12.50
7	19.90	15.00
8	22.40	17.50
9	24.90	20.00
10	27.40	22.50
11	29.90	25.00
12	32.40	27.50
13	34.90	30.00
14	37.40	32.50
15	39.90	35.00
16	42.40	37.50

Specifications / 技术规格:

Current rating: 3A
 额定电流: 3A
 Voltage rating: 250V AC,DC
 额定电压: 250V AC,DC
 Insulation Resistance: 1000MΩ Min.
 绝缘电阻: 最小1000MΩ
 Withstanding voltage: 1000V AC 1Min
 耐压: 1000V AC 1分钟
 Contact Resistance: 20mΩ Max.
 接触电阻: 最大20mΩ
 Operating Temperature: -25°C to +85°C
 工作温度: -25°C 到 85°C

Materials / 材料:
 Contact Material: Brass(Tin plating)
 接触端子材料: 黄铜(镀锡)
 Insulation Material: PA or PBT UL94V-0
 绝缘体塑胶材质: PA 或 PBT UL94V-0

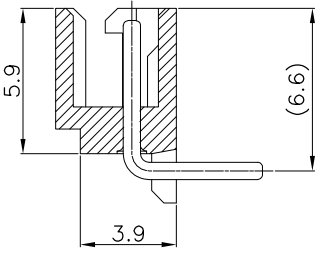
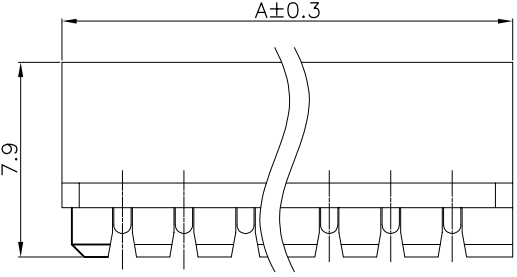

 **浙江快利电子有限公司**
 Zhejiang Kuaili Electronic Co., Ltd

GENERAL TOLERANCE	
X.* ± 3'	X. --
.X* ± 2'	.X ±0.20
.XX* ± 1'	.XX ±0.20
.XXX* ± 0.5'	.XXX --

DESIGN: HELLER	DATE: 2020.11.25
CHECKED:	DATE:
AUDITED:	DATE:
APPROVED:	DATE:

DWG. NO.	TITLE: 5264-NAWD (高温料)
PART NO. KL-5264-NAWD-02-BE	

REV. A	UNIT. MM	SCALE. 1:1	
--------	----------	------------	---